

EAST SIDE TRAIL

Worcester, Mass.



1 inch = 1500 ft.
(REVISED 09/29/11)

THIS MAP WAS PREPARED FROM SCALED DATA INPUT BASED UPON AVAILABLE RECORD PLANS. TRAIL ROUTES AND VARIOUS FEATURES SHOWN HEREON ARE APPROXIMATE ONLY.
DRAWN BY: EFT

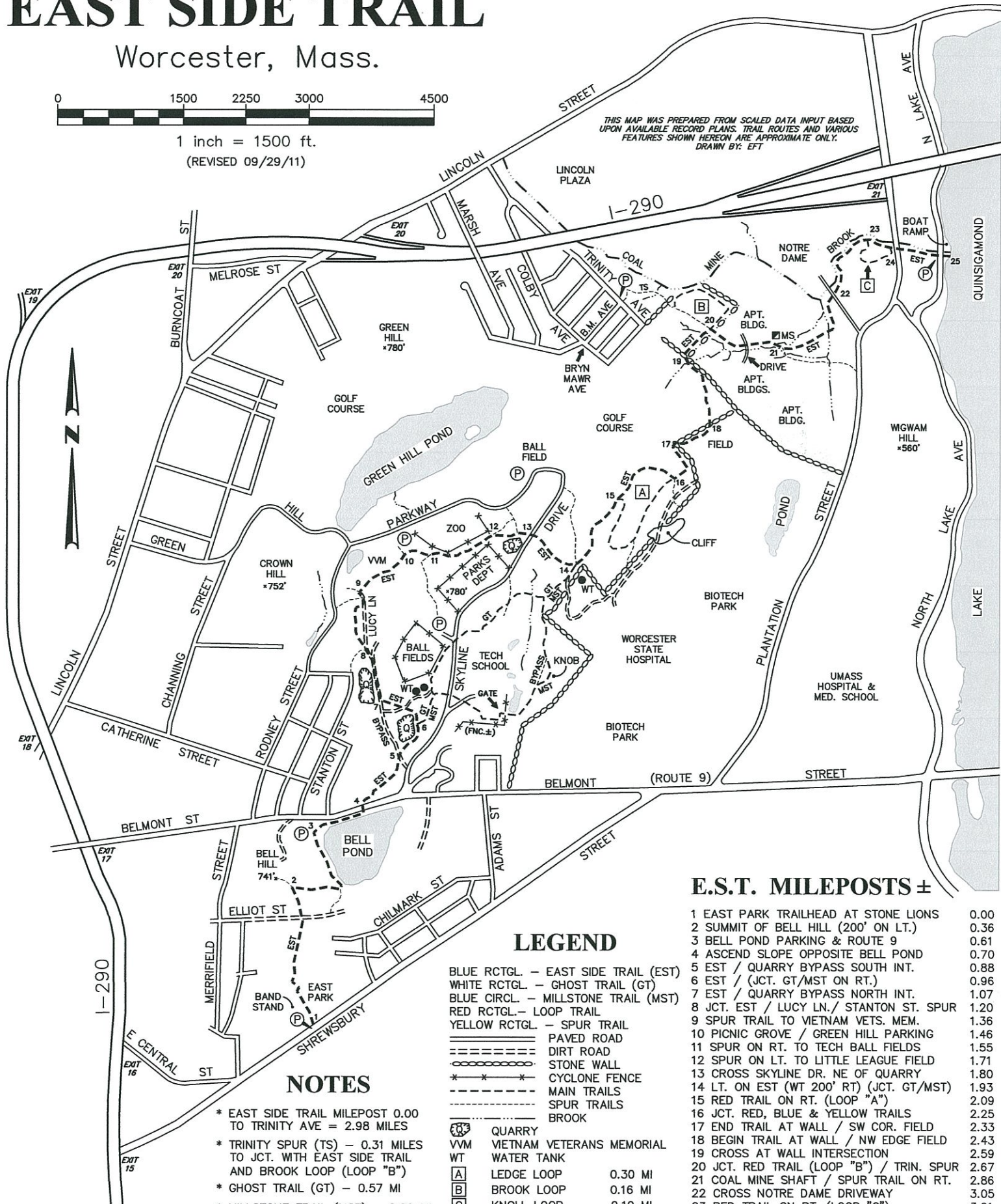

E.S.T. MILEPOSTS ±

1	EAST PARK TRAILHEAD AT STONE LIONS	0.00
2	SUMMIT OF BELL HILL (200' ON LT.)	0.36
3	BELL POND PARKING & ROUTE 9	0.61
4	ASCEND SLOPE OPPOSITE BELL POND	0.70
5	EST / QUARRY BYPASS SOUTH INT.	0.88
6	EST / (JCT. GT/MST ON RT.)	0.96
7	EST / QUARRY BYPASS NORTH INT.	1.07
8	JCT. EST / LUCY LN. / STANTON ST. SPUR	1.20
9	SPUR TRAIL TO VIETNAM VETS. MEM.	1.36
10	PICNIC GROVE / GREEN HILL PARKING	1.46
11	SPUR ON RT. TO TECH BALL FIELDS	1.55
12	SPUR ON LT. TO LITTLE LEAGUE FIELD	1.71
13	CROSS SKYLINE DR. NE OF QUARRY	1.80
14	LT. ON EST (WT 200' RT) (JCT. GT/MST)	1.93
15	RED TRAIL ON RT. (LOOP "A")	2.09
16	JCT. RED, BLUE & YELLOW TRAILS	2.25
17	END TRAIL AT WALL / SW COR. FIELD	2.33
18	BEGIN TRAIL AT WALL / NW EDGE FIELD	2.43
19	CROSS AT WALL INTERSECTION	2.59
20	JCT. RED TRAIL (LOOP "B") / TRIN. SPUR	2.67
21	COAL MINE SHAFT / SPUR TRAIL ON RT.	2.86
22	CROSS NOTRE DAME DRIVEWAY	3.05
23	RED TRAIL ON RT. (LOOP "C")	3.21
24	PLANTATION ST. / RED TRAIL ON RT.±	3.29
25	LAKE QUINSIGAMOND / END EST	3.44

LEGEND

BLUE RCTGL.	— EAST SIDE TRAIL (EST)
WHITE RCTGL.	— GHOST TRAIL (GT)
BLUE CIRCL.	— MILLSTONE TRAIL (MST)
RED RCTGL.	— LOOP TRAIL
YELLOW RCTGL.	— SPUR TRAIL
=====	PAVED ROAD
-----	DIRT ROAD
=====	STONE WALL
-----	CYCLONE FENCE
-----	MAIN TRAILS
-----	SPUR TRAILS
-----	BROOK
VVM	QUARRY
WT	VIETNAM VETERANS MEMORIAL
A	WATER TANK
B	LEDGE LOOP 0.30 MI
C	BROOK LOOP 0.16 MI
P	KNOLL LOOP 0.10 MI
MS	PARKING
MS	MINE SHAFT

NOTES

- * EAST SIDE TRAIL MILEPOST 0.00 TO TRINITY AVE = 2.98 MILES
- * TRINITY SPUR (TS) — 0.31 MILES TO JCT. WITH EAST SIDE TRAIL AND BROOK LOOP (LOOP "B")
- * GHOST TRAIL (GT) — 0.57 MI
- * MILLSTONE TRAIL (MST) — 0.69 MI (MST BLAZED S OF TECH SCHOOL BY FENCE± E TO GATE AT POND)

EAST SIDE TRAIL

Worcester, Mass.

(REVISED 09/29/11)

The East Side Trail was initially conceived in the mid 1980's and envisioned as a continuous greenbelt linking East Park (Cristoforo Colombo Park) with Lake Quinsigamond. Construction of the trail commenced in the spring of 1997 with the original route being completed in a span of just over three weeks. Due to the construction of the Worcester Technical High School at Green Hill Park, a major portion of the trail was relocated away from the school site in the fall of 2003.

The current trail route begins at the twin stone lions marking the entrance to East Park on Shrewsbury Street. Following a walkway through the park, it then climbs steeply to the summit of Bell Hill. The once cleared summit with 360 degree panoramic views, has given way to successive reforestation, beginning with the regrowth of poplar and birch groves. In time, as the forest matures, hardwood species such as oak and maple will become more dominant. Limited views may still be seen to the north and west from the summit vista. Skirting the westerly shores of Bell Pond the trail soon crosses Route 9 and ascends a ledge slope entering into Green Hill Park.

The lands comprising Green Hill Park were first settled in 1755 by Thomas Green. The property passed from father to son until it was deeded to the City in 1905 with the understanding it would remain as a park in perpetuity. Passing an overlook of Bell Pond, the trail reenters the woods following carpaths and a foot trail to the site of an old stone quarry, one of several on Millstone Hill. Much of early Worcester's foundation stone and curbing was quarried from here.

Moving into the core of Green Hill Park the trail travels along a section of Lucy Lane, passing a spur trail on the left to the Vietnam Veterans Memorial, before turning back onto a network of serpentine foot trails. Continuing past the Barnyard Zoo and a small quarry the trail turns east and crosses Skyline Drive. At a cart road junction just north of the blue water tank, the East Side Trail rejoins its original route. The many stone walls in this section were built by a former patient of Worcester State Hospital. Working six days a week, never on Sunday and always alone, the several miles of remaining walls are testament to his more than thirty years of efforts.

Traversing an open field the trail runs alongside, then crosses a stone wall, entering the northerly portions of Green Hill Park. The trail descends through a high canopied forest to a junction with the Coal Mine Brook Loop at a small brook crossing. Heading east over private property, the trail crosses a paved drive before arriving at a ledge overhang, site of the old coal mine shaft. Known as Nackor's mine it produced much coal at first but the coal was of poor quality and the mine was finally abandoned. Nearby Indians used the black lead as part of their war paint.

Passage over other private lands northeast of the shaft, permitted by a trail easement granted in June 2011, allows for an unbroken trail route of nearly 3.5 miles from Shrewsbury Street to Lake Quinsigamond and completes the trail after 14 years of efforts. A new access trail, the Trinity Spur, runs easterly from Trinity Avenue to the intersection of the Brook Loop and East Side Trail.



1" = 2500'

EAST SIDE TRAIL ELEVATION PROFILE

